

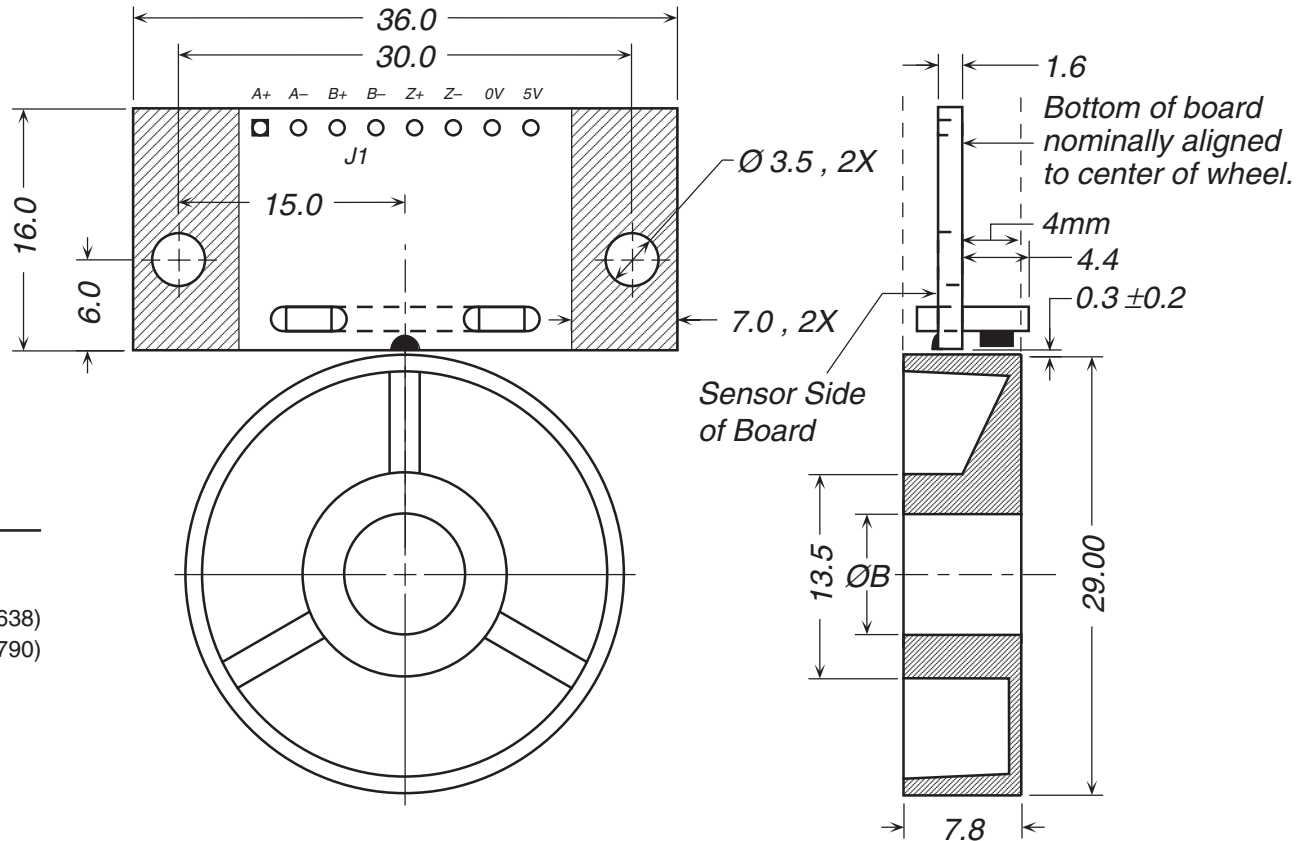

Wheel ID Table (ØB)

KXS1329-xxxx-	Nominal ID (mm)	ID Tolerance ISO	±mm
06	6.00	H7	+0.01, -0.00
08	8.00	H7	+0.01, -0.00
10	10.00	H7	+0.01, -0.00
25	6.35	—	-0.01, -0.03
31	7.94	—	-0.02, -0.03
38	9.53	—	-0.02, -0.03



Wheel Reference Specifications

Mass	5	grams
Inertia	4	gram cm ²
Tensile Strength	480	kg/cm ² (ASTM D-638)
Flexural Strength	840	kg/cm ² (ASTM D-790)
Rockwell Hardness	R110	ASTM D-785

 Sensor mounting area. Free of components and traces (both sides).

REFERENCE		MATERIAL		admotec	
REVISIONS DIMENSIONS IN MILLIMETERS TOLERANCES UNLESS OTHERWISE SPECIFIED .X: ± 0.10 .XX: ± 0.05 ANGLES: ± 0°30'		As shown.		ADMOTEC INC., LEBANON NEW HAMPSHIRE USA	
		HEAT TREAT Not applicable.		KXS1329 Encoder Outline & Mounting	
		FINISH Not applicable.			
THIS DRAWING IS THE PROPERTY OF ADMOTEC INC. IT MAY NOT BE COPIED, USED OR DISCLOSED FOR ANY PURPOSE WITHOUT WRITTEN PERMISSION BY ADMOTEC INC.		DRAWN D Robinson	DATE 15 May 07	DRAWING SIZE A	REVISION —
		CHECKED	DATE	7310-415	
		APPROVED	DATE	SCALE 2:1	SHEET 1 OF 1